



COMPANY PROFILE





HISTORY

We started mass-production of ball bearings in 1968. Since then bearings have been produced in ZVL SLOVAKIA, a.s. uninterruptedly for almost 50 years despite numerous changes in management structure. Additional bearing lines have been gradually introduced and today we supply comprehensive bearing range to important producers of machinery and devices in various industries worldwide.

1968 Present

PRESENT

Our wide distribution network enables us to keep in touch with our customers and strenghtens presence of ZVL brand in the world market. It also offers a base for service tasks and many other special requirements.



INDUSTRY SECTORS WITH ZVL BEARINGS

We have built long-term relationships with many satisfied OEM users and the aftermarket internationally.



ENGINEERING INDUSTRY

- Industrial Gear-boxes
- Drivetrains / Axles
- Motors and Generators
- Pumps / Compressors
- Electric Motors
- Machine Tools
- Clutches
- Home Appliances
- Conveyor Belts



HEAVY INDUSTRY

- Steel
- Mining
- Processing Industry
- Energy
- Cement
- Paper and Pulp Processing



AGRICULTURE

- Tractors
- Harvesters
- Cutters
- Sow machines
- Cultivators
- Forestry machines

PRODUCT DEVELOPMENT AND MANUFACTURING

Thanks to our long-term close cooperation with our customers we are able to offer optimal technical solutions and support to bearing users when choosing the best product from our wide product range.

R & D department is an integral part of ZVL SLOVAKIA, a.s. We use CAD, 3D CAD designing programs to project and develop new products. We also cooperate with technical universities and external testing laboratories. Our strong R & D team is ready to assist our customers in:

- materials, lubrication and tribology
- quality standards and feasibility of new bearing designs
- identification of problems causing bearings and machines failures

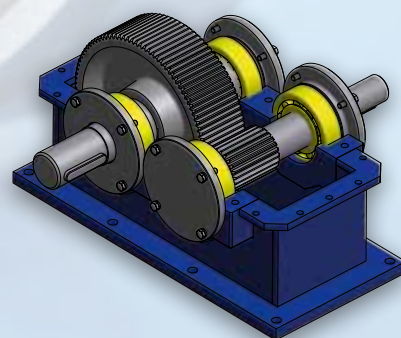

PRODUCT

ZVL brand has been a synonym of quality and reliability for almost 50 years. The comprehensive product range makes, ZVLSLOVAKIA, a.s. one of the important international bearing suppliers. Thanks to decades of experience and strong technical know-how we became a reliable partner to our customers in various industrial sectors offering technical support directly at the customer's.

BALL BEARINGS

- Single row deep groove ball bearings
- Single row angular contact ball bearings
- Single row four-point angular contact ball bearings
- Double row angular contact ball bearings
- Double row self-aligning ball bearings
- Single direction and double direction thrust ball bearings

CYLINDRICAL ROLLER BEARINGS

- Single row cylindrical bearings
- full complement cylindrical bearings
- cylindrical roller thrust bearings

SPHERICAL ROLLER BEARINGS

- Double row spherical bearings
- spherical roller thrust bearings

NEEDLE BEARINGS

INSERT BALL BEARINGS AND INSERT
BALL BEARINGS HOUSING UNITS
SPHERICAL PLAIN BEARINGS
SPECIAL BEARINGS
ACCESSORIES



QUALITY

Quality management system introduced to continuously improve quality of our production is certified in accordance with international standards ISO 9001, ISO 14001 and ISO 45001. Quality inspection of input materials and components is equally important to us. Material of bearing rings and rolling elements is according to standard ISO 683-17. ZVL SLOVAKIA, a.s. supports modern measuring and testing laboratories and inspection laboratory for precision measuring.



ZVL bearings are used in:



Steel Industry



Cement Industry



Mining Industry



Paper Industry



Electric Motors



Energy Industry



Agriculture



Automotive



Machine Tools



Forestry Machines

COMPANY PROFILE /02/2016

ZVL SLOVAKIA, a.s. • Na stanicu 22 • 010 09 Žilina • Slovakia
Phone: +421 41 707 60 32 • Fax: +421 41 707 60 24
sales.zvl@zvllovakia.sk • www.zvllovakia.sk